

H:\23299\PARCEL 2&3\PL2 STAGE 6\CAD\DWG SET\ROAD AND DRAINAGE\23299\_6R2\_8-10.DWG

THIS DRAWING IS NOT TO BE COPIED OR SCALED

VERSION	REMARKS	DATE	BY
C	COUNCIL COMMENTS	10.08.23	JS
B	COUNCIL COMMENTS	11.04.22	JS
A	PRELIMINARY ISSUE	22.03.22	JS

	DRAIN, PROPERTY INLET & PIT
	SEWER AND MAINTENANCE HOLE
	GAS MAIN, VALVE & HYDRANT
	WATER MAIN, VALVE & HYDRANT
	ELECTRICAL POLE & PIT
	GAS MAIN, VALVE & HYDRANT
	ELECTRICAL SERVICES & PITS
	EX COMMS SERVICES & PITS

	RECYCLED WATER
	ELECTRICAL U.G. SERVICES
	ELECTRICAL SERVICE & PIT
	EX ELECTRICAL ASSETS
	GAS & WATER CONDUITS
	STREET SIGN
	DRAINAGE PIT No. TBM
	EX FENCE
	EX WALL OR BUILDING

	FINISHED SURFACE AFTER CUTTING OR FILLING
	TOP OF PROPOSED BATTER
	PROPOSED PAVEMENT OR FOOTPATH SURFACE
	EXISTING OR PROPOSED INVERT LEVEL OF PIPE OR OPEN DRAIN
	TANGENT POINT
	CHAINAGE
	PSM

DRAWN BY	H.MARES	DESIGNED BY	J.SIGABALAVU
MELWAY	343 H7	CHECKED BY	-
DATUM	AHD	AUTHORISED BY	-

**REEDS CONSULTING**

www.reedsconsulting.com.au  
engineering@reedsconsulting.com.au

Lvl 16, 501 Swanston Street Melbourne Victoria 3000  
p (03) 8660 3000

LAND SURVEYING  
CIVIL ENGINEERING  
PLANNING  
DEVELOPMENT CONSULTING

Copyright © Reeds Consulting Pty Ltd  
All Rights Reserved 2001

**WARNING**

BEWARE OF UNDERGROUND SERVICES

THE LOCATIONS OF UNDERGROUND SERVICES ARE APPROXIMATE ONLY AND THEIR EXACT POSITION SHOULD BE PROVEN ON SITE. NO GUARANTEE IS GIVEN THAT ALL EXISTING SERVICES ARE SHOWN.

**PRELIMINARY PLAN ONLY**  
NOT APPROVED FOR CONSTRUCTION

CITY OF MELTON  
59-85 ALFRED ROAD, STRATH TULLOH  
BALMORAL ESTATE - PARCEL 2&3, STAGE 6  
LAYOUT PLAN

DRAWING No. 6R2  
REFERENCE 23299E/P2/6  
SHEET 2 OF 17

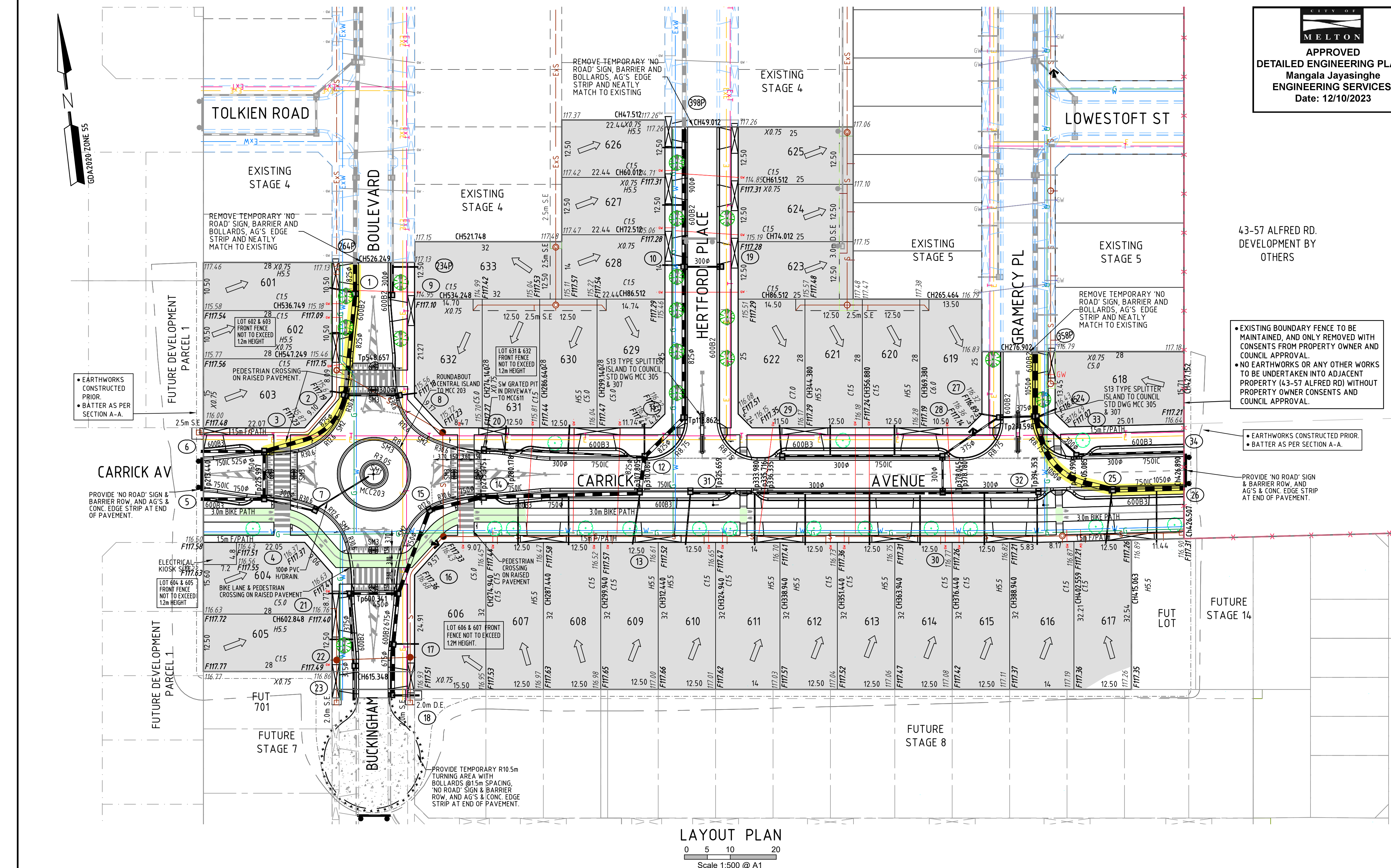

**MELTON**

APPROVED  
DETAILED ENGINEERING PLANS  
Mangala Jayasinghe  
ENGINEERING SERVICES  
Date: 12/10/2023

**LEGEND**

- TEMPORARY TURNING AREA INCLUDING BOLLARDS AND 'NO ROAD' SIGN.
- PROPOSED GAS & WATER CONDUITS
- DIRECTION OF LEGAL POINT OF DISCHARGE
- OVERLAND FLOW PATH DIRECTION
- EXISTING TREES TO BE REMOVED
- PROPOSED PASSIVE STREET TREE IRRIGATION GRAVEL TRENCH WITH KERB INLET DIVERSION (ONE TREE PIT PER LOT)
- STREET TREE. PASSIVE IRRIGATION NOT PROVIDED DUE TO PHYSICAL RESTRAINT.
- PROPOSED SCHEME DRAINS (COUNCIL OWNED & MAINTAINED)

**TYPICAL NOTATIONS - EXAMPLE**  
NOT TO SCALE

H5.5 - PROPERTY DRAIN AT 5.5m OFFSET WHERE DRAIN IN NON-PERPENDICULAR, O/S REFERS TO INTERSECTION OF DRAIN & BL.  
C5.0 - GWR CONDUIT AT 5.5m OFFSET  
X0.75 - RESIDENTIAL CROSSING AT 0.75m OFFSET

PROPOSED SINGLE RESIDENTIAL VEHICLE CROSSING AS PER EDM 501. OFFSET IS AS PER EDM 501 IF NOT SHOWN.

NOTE: ALL OFFSETS ARE MEASURED ALONG THE ROAD RESERVE BOUNDARY AND FROM NEAREST SIDE TITLE BOUNDARY.

**PROPOSED TREES**

- STREET TREES TO HAVE PASSIVE TREE IRRIGATION.
- TREE'S SHOWN INDICATIVE ONLY, REFER TO LANDSCAPE PLANS FOR COUNCIL APPROVED STREET TREE'S LAYOUT AND LOCATION.

**EXISTING TREES AND FENCES.**

- ALL EXISTING TREES WITHIN THE DEVELOPMENT BOUNDARY ARE TO BE REMOVED AS PER TREES REMOVAL REPORT.
- ALL EXISTING FENCES WITHIN THE DEVELOPMENT BOUNDARY ARE TO BE REMOVED.

**SECTION A-A  
EARTHWORKS - BERM DETAIL**  
N.T.S.

BOUNDARY LINE  
FENCE BY DEVELOPER.  
BERM  
CUT-OFF DRAIN AS REQUIRED. REFER TO DETAIL.

**EARTHWORKS LEGEND**

- FILL EARTHWORKS - FILL AREA WITHIN LOTS GREATER THAN 150mm DEPTH
- CUT EARTHWORKS - CUT AREA WITHIN LOTS GREATER THAN 150mm DEPTH

THIS PLAN SHOWS APPROXIMATE EXTENTS OF CUT AND FILL TO BE UNDERTAKEN DURING CONSTRUCTION OF THE WORKS BASED ON THE EXISTING SITE SURFACE LEVELS AND PROPOSED FINISHED DESIGN LEVELS SHOWN.  
THE EXTENT OF FILL SHOWN IS BASED ON DESIGN AND MAY BE SUBJECT TO CHANGE DURING CONSTRUCTION.  
THE DEPTH OF TOP DRESSING FILL MAY VARY BY UP TO 0.15m.